

CLASSIC CL4500XH
Extra High
2 Post 4.5 Tonne
Clearfloor Hoist





CLASSIC CL4500XH

- **The CLASSIC CL4500XH is a new extremely high lifting 2 post lift. Lifting height up to 2000mm (not included the extension adapters). Two pieces columns and top beam make the installation and shipment to be simple.**
- **The CL4500XH has used the extremely long carriages as CL4500, the carriages are 2 times longer than most of the carriages of our competitor's products.**
- **4500kg (10,000 lbs) Capacity.**
- **• Dual Direct-drive cylinders, designed and made on a high standard, with high-quality oil seals.**
- **• Aero cable used for synchronization.**
- **• Single-point safety release, and dual safety design.**
- **• 4 three-stages arms are suitable for more vehicles.**
- **• 2 pieces of columns structure allow height-adjustable installation.**
- **• Automatic arms restraints.**
- **• Self-lubricating UHMW Polyethylene sliders and bronze bush.**
- **• Overhead safety shut-off device.**
- **• Detachable foot guard and tool trays.**
- **• Adjustable double screw lift pads are included with the Classic CL4500XH**
- **Warranty:**
- **1 Year Warranty on electrical and hydraulics including Hoist Rams / 5-year structural warranty.**
- **Registered with Worksafe**

CLASSIC CL4500XH SPECIFICATIONS

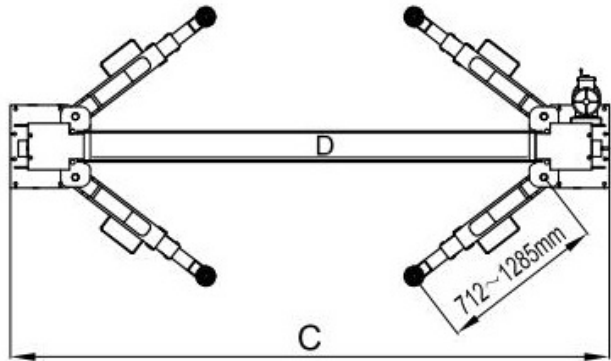
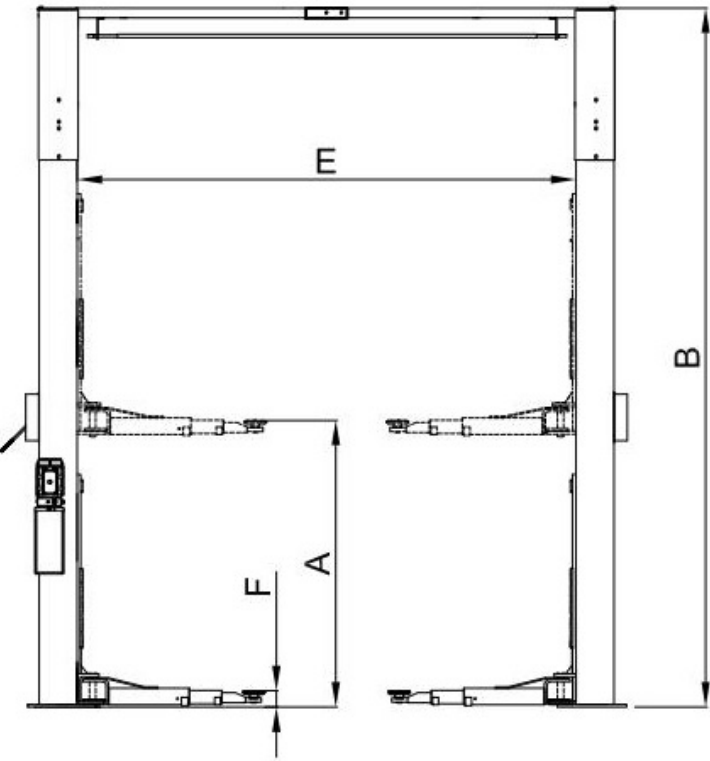

Model	CLASSIC CL4500XH
Lifting Capacity	4500kg (10,000 lbs)
Lifting Time	61 Seconds
Lifting Height	A 2000-2229mm
Overall Height	B 4035/4313mm
Overall Width	C 3666mm
Drive-Thru Clearance	D 2710mm
Width Between Columns	E 3000mm
Minimum Pad Height	F 90 mm
Gross Weight	803Kg
Motor	3.0HP